

- A Hospital Main Entry**
Major Vehicular Drop-off
Major Vehicular carpark access
- B Hospital Village Green**
Major Pedestrian Space
- C New Neighbourhood Centre**
Mix of Commerical/Retail/Residential
Commerical/Retail spill space
Public seating/landscaping
- D Existing Neighbourhood Centre**
Retail centre with limited open space

- Pedestrian Pathways, proposed and existing
- Pedestrian and Cycle Pathways, proposed and existing
- Controlled or zebra Pedestrian Crossings
proposed and existing
- New estate bicycle storage area
- Traffic Lights proposed and existing

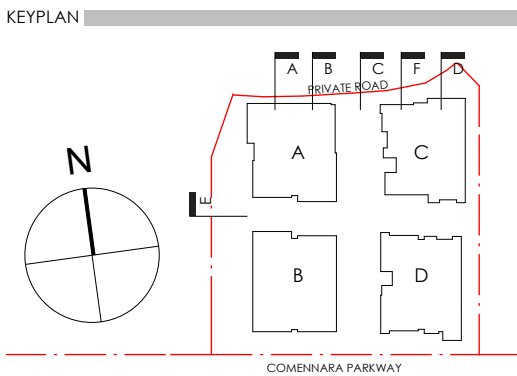

ARCHITECT

MBMO

ARCHITECTS

188 Willoughby Rd T +61 2 9439 6622
Crows Nest NSW 2065 info@mbmo.com.au
ABN 90 150 671 051 www.mbmo.com.au
NSW Nominated Architect: Cameron Martin 9194

DEVELOPMENT MANAGER/CLIENT

SEVENTH DAY ADVENTIST CHURCH

PROJECT

SPD RESIDENTIAL
185 Fox Valley Road
Wahroonga

DRAWING NAME

ESTATE ACCESS DIAGRAM

SCALE	DRAWN	DA-29
1:2000	@A2 MS	
QA	PLOTDATE	JOB No
SO	22/05/2014	11042
		ISSUE
		[B]

11042 CN 02a.ph